

Huffman HS - 1st Floor

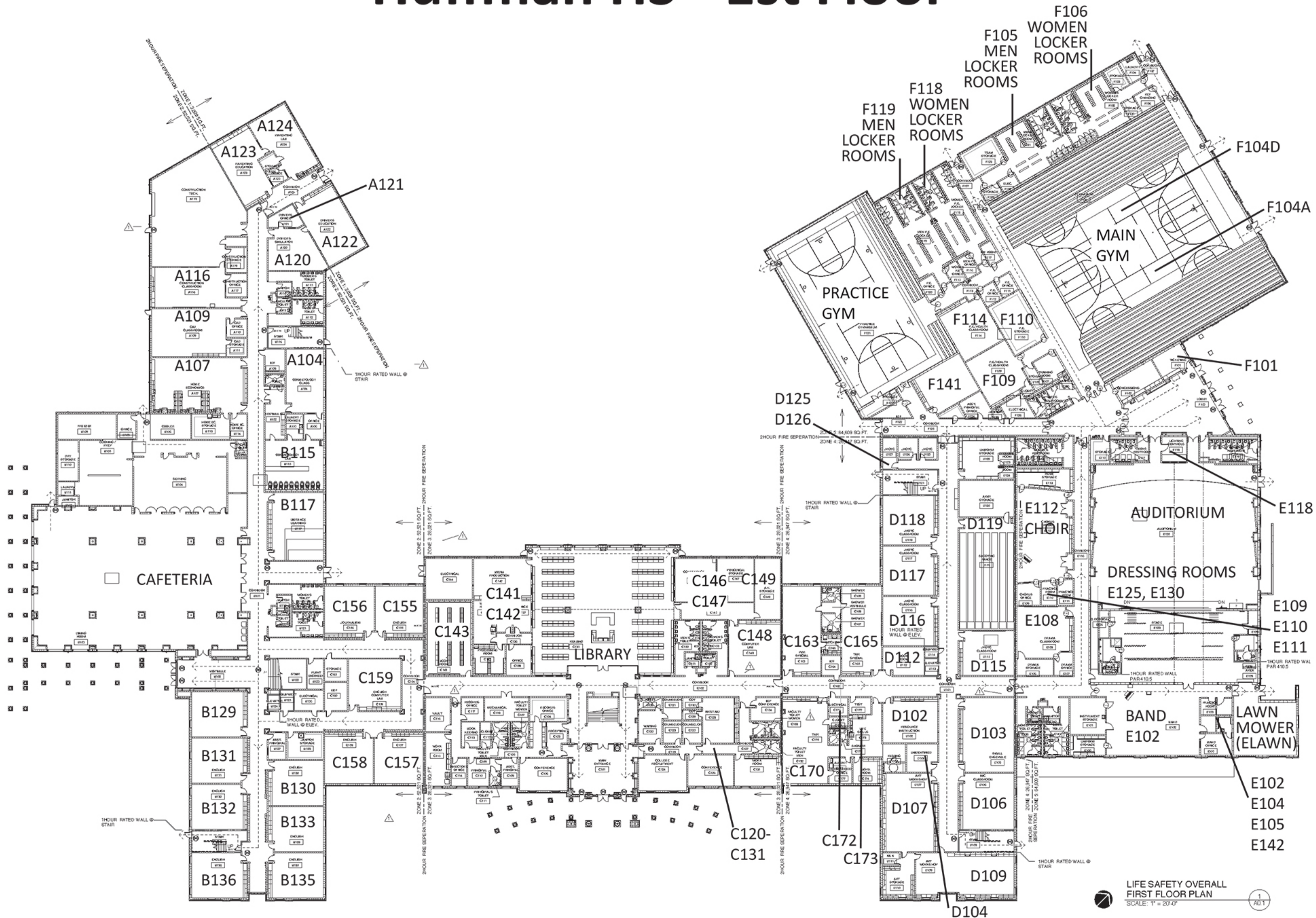

Huffman HS - 2nd Floor

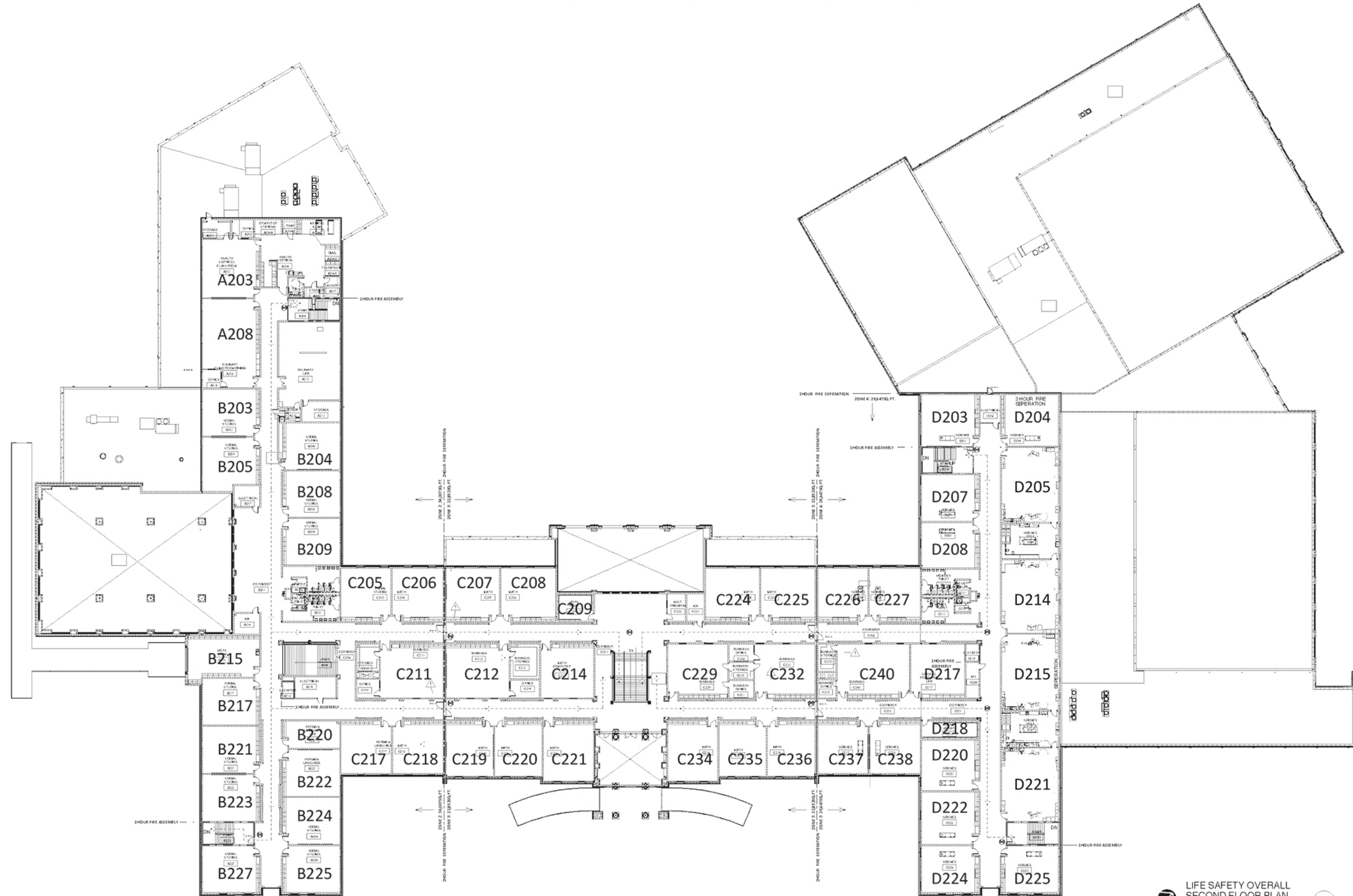

Huffman Survival Guide

Huffman is a very nice but rather confusing building. This brief guide is intended to help you navigate the school.

General Information

The building rooms go from A to F. As are to your left as you exit the Cafeteria, along with B115 and B117. All other Bs are to the right of the Cafeteria. Cs are split on both sides of the library, and in weird numerical order.

All 100s are on the first floor, all 200s are on the second floor.

E Rooms are largely practice rooms inside of larger rooms (Band, Choir, and Drama), and are largely used for POI. Competitors waiting to perform in one of these smaller rooms should wait QUIETLY in the larger room.

F Rooms include locker rooms and spaces in the gym, as well as a few class rooms. There will be performers in the far corners of the Main Gym, so please be QUIET while passing through the Main Gym to other rooms.

All G Rooms are in the "Field House." It is a separate building on the opposite side of the school from the Cafeteria. Exit from the E or F Areas to get there. "GLocker" is the locker room in the Field House, NOT a Girls' Locker Room in the main building.

Room Changes and Clarifications (High School National Tournament)

Section 26 of the HI Schematic lists the room as "208" - this is an error. The correct room is **D208**.

Section 24 of the POI Schematic lists the room at C206. The correct room is **F101**.

Section 21 of the DI Schematic lists the room as F101. The correct room is **C206**.

Section 26 of the POI Schematic list the room as C231. The correct room is **C143**.

Unusual Room Locations

E104, E105, E142 and E Lawn ("Lawnmower shed") are through Band Room.
Go to the Band Room (E102). E104, E105, E142 are all practice rooms. They are POI rooms that will take one competitor at a time. Others should wait QUIETLY in the band room. The Lawnmower Room is a DI room, also accessed via the band room, and all participants should be in the room when the round starts.

F104A and F104D are in the Main Gym.
The Main Gym is different from the Practice Gym (where judge hospitality is located). It is located across from the Auditorium.

F105, F106, F118, and F119 are Locker Rooms.
F105 and F106 can be accessed through doors in the back corners of the Main Gym. F118 and F119 can be accessed through the hallway that connects the Main Gym and the Practice Gym.

E125, E130, and E118 are in the Auditorium.
E118 is the Sound Booth, just inside the doors - DO NOT touch the equipment. E125 and E130 are Dressing rooms. To get to them, you need to go up onto the main stage and look behind the stage.

A104 and B115 are accessed via A102.
Please do not touch the cosmetology equipment and chairs in these rooms.

C141, C142, C146, and C149 are all accessed via the library.
QUIETLY enter the library and follow the signs around the edge of the room to your competition room.

F101 is the ticket room.
It can be found across from the entrance to the auditorium, by the exterior doors.

F107 is not labeled on the map.
It is immediately next to F109 and F110.

E106 and E107 are not labeled on the map.
They are practice rooms within E108, the Drama Room.